

Portalampada Edison

Edison Lamp-holders



ATTACCO/ CAP

E40

Art. 076.2

Per lampade ad incandescenza
e scarica

*For incandescent lamps and
discharge lamps*

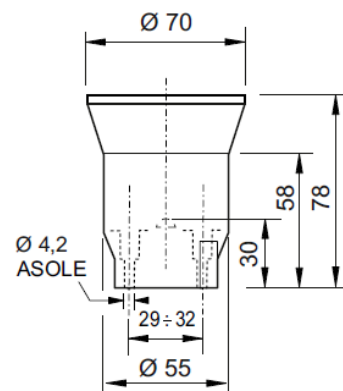

DATI TECNICI

TECHNICAL DATA

Tensione nominale:	500 V
Corrente nominale:	16 A
Temperatura di funzionamento:	T210°C
Tensione d'impulso max:	5 kV
Categoria di tenuta all'impulso:	III
Tipo di connessione conduttori:	Morsetto
Capacità connessione morsetti:	1 ÷ 4 mm ²
Corpo in porcellana	
Contatto centrale in bronzo fosforoso nichelato	
Virola in lastra di ottone nichelato	
Conforme direttiva:	2006/95/CE
Marchi di qualità	

Rated voltage:	500 V
Rated current:	16 A
Nominal highest working temp.	T210°C
Maximum rated pulse voltage	5kV
Impulse withstand category	III
Type of connection	Terminal
Terminals connection capacity:	1 ÷ 4 mm ²
Porcelain body	
Nichel-plated phosphor bronze central contact	
Brass plate nickel plated bulb screw base	
In conformity with directive	2006/95/CE
Quality Standards	

Portalampada *lamp-holder*

Ø76.2 versioni disponibili / *available versions*

Ø76.2/SM

Portalampada E40. Interasse 29÷32mm con molla antisvitamento

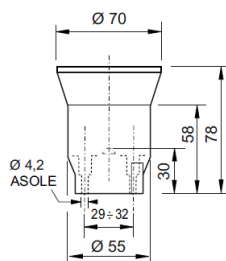

Ø76.2/SM

Porcelain lampholder E40. Fixing wheelbase from 29 to 32mm

Ø76.2/M

Con staffa diritta esterna in ferro zincato.

Interasse di fissaggio 51÷57mm.

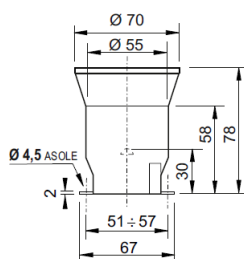

Ø76.2/M

With straight galvanized iron fixing bracket.

Fixing wheelbase from 51 to 57 mm.

Ø76.2/PM

Assemblato con raccordo in alluminio pressofuso. Filetto femmina da 3/8 G con vite di bloccaggio Tige.

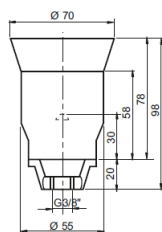

Ø76.2/PM

Assembled with die-cast aluminium jumper connection 3/8 G female thread with Tige locking screw.